

EXCHANGING HEATING ELEMENT

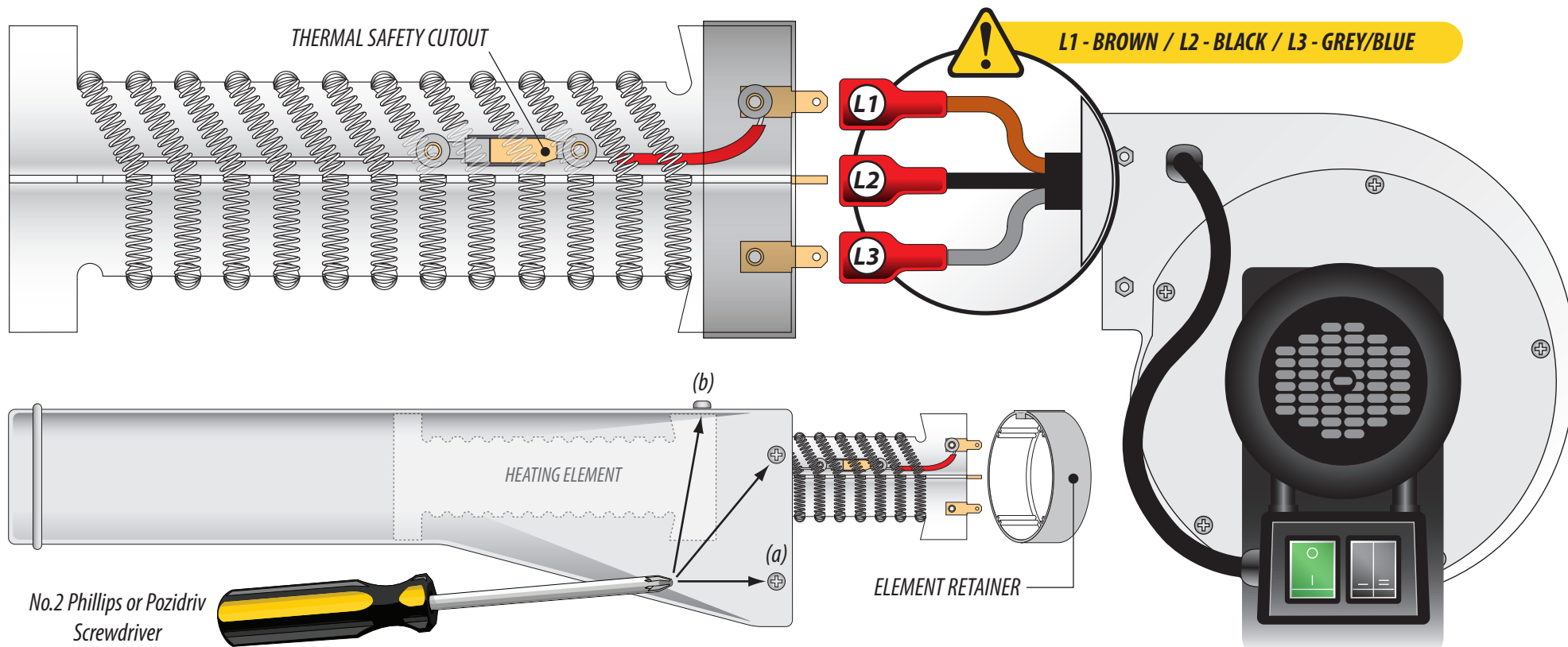

ELECTRICAL SHOCK HAZARD!

Failure to follow proper safety procedures could result in death or serious injury.

ALWAYS...

Disconnect power prior to servicing.
Replace and secure parts before operating.

FITTING INSTRUCTIONS:

1. Remove 4x screws (a) and detach dryer nozzle.
2. Disconnect wires (L1,L2,L3) from existing heating element.
3. Remove screw (b) and extract element assembly.
4. Clean nozzle interior to remove accumulated dust and grime.
5. Fit new element assembly and secure with screw (b).
6. Attach wires (L1,L2,L3) as indicated above.*
7. Refit nozzle and secure with 4x screws (a).
8. Ensure all parts are firm and secure before testing.

* Cable colours may differ according to age of appliance. Ensure L1 (brown) is connected to the element thermal safety cutout.